



Rule Changes from the Executive

Issue #2016-1 Published 4-2-16

Updates underlined:

Rule N12.1 Rotax Max

Replace the current Rule with the following:

N12.1 Engine Technical Specifications are under the control of KartSport New Zealand Executive in conjunction with Rotax. The KartSport New Zealand Executive reserves the right to alter the class specifications to ensure fairness of competition, safety and the wishes of the competitors. Only written submissions will be accepted for changes, with the Executive acting on them if considered necessary.

VARIANT OPTIONS:

- Pre EVO Rotax FR125 Max with option of Series 1, 2 or 3 (new) exhaust system.
OR
- Pre EVO Rotax FR125 Max with full EVO Kit except for: new Series 3 exhaust system, new crankshaft, new con rods and new piston which are all optional.
OR
- Complete new Rotax FR125 Max EVO engine with new Series 3 exhaust only.
- EVO1 loom, components and mounts are legal only until 30-4-16.
- EVO2 loom, components and mounts are legal from 1-2-16.

NOTE: No Mixing and Matching

- The mixing of pre EVO and EVO components is limited to:
- A new EVO engine must be run with **ALL** components supplied including the new Series 3 exhaust system.
- A pre EVO engine with an EVO Kit upgrade must run with **ALL** EVO Kit components except the new Series 3 exhaust system, new con rod, new crankshaft and new piston which are all optional.
- A pre EVO engine (circa Dec 2014 specifications) without the EVO Kit must run with **ALL** pre EVO components with the following exceptions: new Series 3 exhaust system, new crankshaft, new con rod and new piston are optional.

Implementation: *Immediate (force majeure)*

Reason: Update from Rotax. For details of the no charge loom exchange programme go to:
<http://www.kartsport.org.nz/about-us/hot-topics/rotax-evo-loom-replacement>

Rule N12.9.4 Rotax Max Dellorto Ignition System (EVO):

Replace the current Rule with the following:

N12.9.4 Dellorto Ignition System (EVO): Removing black coating of the gearbox cover in specific areas defined by Rotax (for mass connection between cable harness and engine) is a legal modification. Ignition coil with separate electronic box (ECU, specific for every engine). Ignition coil and electronic box have to be fitted by means of the corresponding brackets and components according to either of the illustrations below. Only the EVO2 loom, brackets and components are permitted from 1-5-16.

EVO1

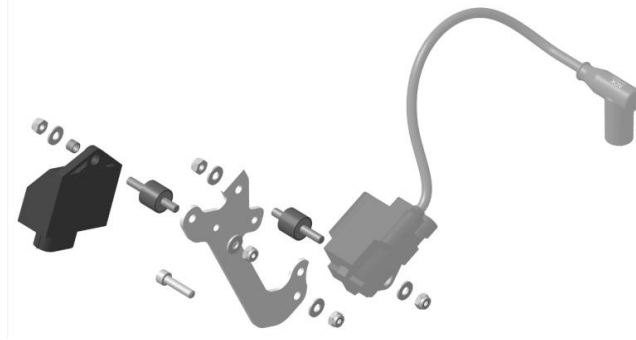

The ground cable of the cable harness has to be connected to the engine at the rear left allen screw of the cylinder head cover.

The magnet valve must be mounted by means of a rubber buffer to the support plate.



EVO2



The ground cable of the cable harness has to be connected to the lower rubber buffer of the support plates.

The visual appearance of the ignition coil must be identical with the pictures. Ignition coil must show 2 pins at the terminal. The ignition coil is labeled with two stickers, "BRP 666820" and "NIG 0105". The ignition coil is still legal to be used also if one or both stickers disappeared. Silent blocks should be used to mount the ignition coil.



The FR125 Max electronic box is labelled with sticker "666814, 125 MAX evo" and is still legal if the sticker has disappeared.
Full EVO loom including start/stop buttons must be used.

Implementation: *Immediate (force majeure)*

Reason: Update from Rotax. For details of the no charge loom exchange programme go to:
<http://www.kartsport.org.nz/about-us/hot-topics/rotax-evo-loom-replacement>

Rule N14.1 Rotax Junior Max

Replace the current Rule with the following:

N14.1 Engine Technical Specifications are under the control of KartSport New Zealand Executive in conjunction with Rotax. The KartSport New Zealand Executive reserves the right to alter the class specifications to ensure fairness of competition, safety and the wishes of the competitors. Only written submissions will be accepted for changes, with the Executive acting on them if considered necessary.

VARIANT OPTIONS:

- Pre EVO Rotax FR125 Junior Max with option of Series 1, 2 or 3 (new) exhaust system.
OR
- Pre EVO Rotax FR125 Junior Max with full EVO Kit except for: new Series 3 exhaust system, new crankshaft, new con rods and new piston which are all optional.
OR
- Complete new Rotax FR125 Junior Max EVO engine with new Series 3 exhaust only.
- EVO1 loom, components and mounts are legal only until 30-4-16.
- EVO2 loom, components and mounts are legal from 1-2-16.

NOTE: No Mixing and Matching

- The mixing of pre EVO and EVO components is limited to:
- A new EVO engine must be run with **ALL** components supplied including the new Series 3 exhaust system.
- A pre EVO engine with an EVO Kit upgrade must run with **ALL** EVO Kit components except the new Series 3 exhaust system, new con rod, new crankshaft and new piston which are all optional.
- A pre EVO engine (circa Dec 2014 specifications) without the EVO Kit must run with **ALL** pre EVO components with the following exceptions: new Series 3 exhaust system, new crankshaft, new con rod and new piston are optional.

Implementation: *Immediate (force majeure)*

Reason: Update from Rotax. For details of the no charge loom exchange programme go to:
<http://www.kartsport.org.nz/about-us/hot-topics/rotax-evo-loom-replacement>

Rule N14.9.4 Rotax Junior Max Dellorto Ignition System (EVO):

Replace the current Rule with the following:

N14.9.4 Dellorto Ignition System (EVO): Removing black coating of the gearbox cover in specific areas defined by Rotax (for mass connection between cable harness and engine) is a legal modification. Ignition coil with separate electronic box (ECU, specific for every engine). Ignition coil and electronic box have to be fitted by means of the corresponding brackets and components according to either of the illustrations below. Only the EVO2 loom, brackets and components are permitted from 1-5-16.

EVO1

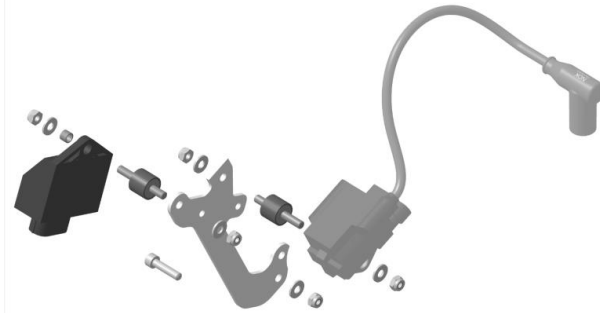

The ground cable of the cable harness has to be connected to the engine at the rear left allen screw of the cylinder head cover.

EVO2



The ground cable of the cable harness has to be connected to the lower rubber buffer of the support plates.

The visual appearance of the ignition coil must be identical with the pictures. Ignition coil must show 2 pins at the terminal. The ignition coil is labeled with two stickers, "BRP 666820" and "NIG 0105". The ignition coil is still legal to be used also if one or both stickers disappeared.

Silent blocks should be used to mount the ignition coil.

The ground cable of the cable harness has to be connected to the engine at the rear, left Allen screw of the cylinder head cover.



The FR125 Junior Max electronic box is labelled with sticker "666812, 125 Junior MAX evo" and is still legal if the sticker has disappeared.

Full EVO loom including start/stop buttons must be used.

Implementation: *Immediate (force majeure)*

Reason: Update from Rotax. For details of the no charge loom exchange programme go to: <http://www.kartsport.org.nz/about-us/hot-topics/rotax-evo-loom-replacement>

Rule N16.1 Rotax DD2

Replace the current Rule with the following:

N16.1 Engine Technical Specifications are under the control of KartSport New Zealand Executive in conjunction with Rotax. The KartSport New Zealand Executive reserves the right to alter the class specifications to ensure fairness of competition, safety and the wishes of the competitors. Only written submissions will be accepted for changes, with the Executive acting on them if considered necessary.

VARIANT OPTIONS:

- Pre EVO (ref Rules Issue 2014-7) Rotax DD2 (except for updated squish) with option of Series 1, 2 or 3 (new) exhaust system.
OR
- Pre EVO (ref Rules Issue 2014-7) Rotax DD2 (except for updated squish) with full EVO Kit except for: new Series 3 exhaust system, new crankshaft, new con rod and new piston which are all optional.
OR
- Complete new DD2 EVO engine with new Series 3 exhaust only.
- EVO1 loom, components and mounts are legal only until 30-4-16.
- EVO2 loom, components and mounts are legal from 1-2-16.

NOTE: No Mixing and Matching

- The mixing of pre EVO and EVO components is limited to:
- A new EVO engine must be run with **ALL** components supplied including the new Series 3 exhaust system.
- A pre EVO engine with an EVO Kit upgrade must run with **ALL** EVO Kit components except the new Series 3 exhaust system, new con rod, new crankshaft and new piston which are all optional.
- A pre EVO engine (circa Dec 2014 specifications) without the EVO Kit must run with **ALL** pre EVO components with the following exceptions: new Series 3 exhaust system, new crankshaft, new con rod and new piston are optional.

Implementation: *Immediate (force majeure)*

Reason: Update from Rotax. For details of the no charge loom exchange programme go to: <http://www.kartsport.org.nz/about-us/hot-topics/rotax-evo-loom-replacement>

Rule N14.9.4 Rotax DD2 Dellorto Ignition System (EVO):

Replace the current Rule with the following:

N16.9.4 Dellorto Ignition System (EVO): Removing black coating of the gearbox cover in specific areas defined by Rotax (for mass connection between cable harness and engine) is a legal modification. Ignition coil with separate electronic box (ECU, specific for every engine). Ignition coil and electronic box have to be fitted by means of the corresponding brackets and components according to either of the illustrations below. Only the EVO2 loom, brackets and components are permitted from 1-5-16.

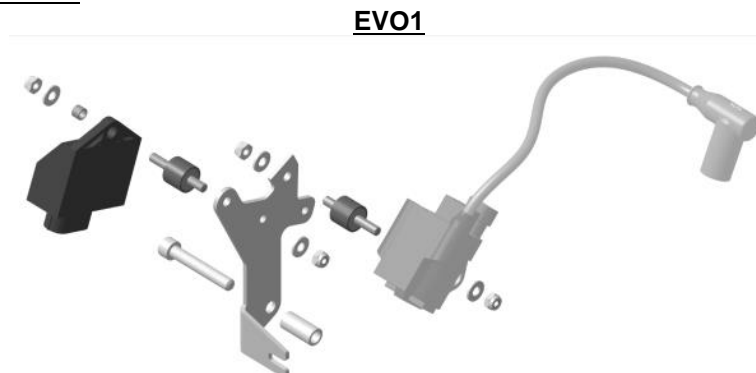

The ground cable of the cable harness has to be connected to the engine at the rear left allen screw of the cylinder head cover.

The magnet valve must be mounted by means of a rubber buffer to the support plate.



EVO2



The ground cable of the cable harness has to be connected to the lower rubber buffer of the support plates.

The visual appearance of the ignition coil must be identical with the pictures. Ignition coil must show 2 pins at the terminal. The ignition coil is labeled with two stickers, "BRP 666820" and "NIG 0105". The ignition coil is still legal to be used also if one or both stickers disappeared. The ground cable of the cable harness has to be connected to the engine at the rear, left Allen screw of the cylinder head cover.



The DD2 electronic box is labelled with sticker “666816, 125 MAX DD2 evo” and is still legal if the sticker has disappeared.
Full EVO loom including start/stop buttons must be used.

Implementation: *Immediate (force majeure)*

Reason: Update from Rotax. For details of the no charge loom exchange programme go to:
<http://www.kartsport.org.nz/about-us/hot-topics/rotax-evo-loom-replacement>